

# SHOWER CHAIRS



## AquaMaster Tilt in Space Shower & Toileting Chair

**New**

Maximum Load 160kg (25 stones) (350lb)

- Designed and tested in conjunction with Occupational Therapists and healthcare professionals
- Offers a safe, controlled and comfortable showering position for those with severe physical conditions
- Full range of aperture, horseshoe and flat padded seats available
- Option for bespoke seating, including pressure relief foam
- Armrest, backrest and footrest options
- Twin gas rams to ensure smooth reliable operation
- Single hand control lever for ease of use
- Stainless steel, powder coated construction for strength and durability
- Corrosion resistant stainless steel and nylon braked castors. Directional locking castor available.
- Commode cradle options for round or oval pan types

code	product	description	Price
A14	AquaMaster Tilt in Space 18" frame	Horseshoe, Aperture, Flat Padded Seat 18" (460mm)	from <b>£899</b>
A15	AquaMaster Tilt in Space 21" frame	Horseshoe, Aperture, Flat Padded Seat 21" (510mm)	from <b>£950</b>

## Tilt in Space Shower chair custom made features

selection	description	Price
<b>Chair width</b>	Available in custom widths (please specify width)	<b>£141</b>
<b>Height</b>	Raise or lower seat height (state height, max + 150mm/6")	<b>£105</b>
<b>Backrest options</b>	Additional recline (state angle of recline max 10 degrees)	<b>£28</b>
	Additional recline (over 10 degrees)	<b>£83</b>
	Height change (state height required)	<b>£39</b>
	Full height backrest material	<b>£22</b>
	Full height backrest fabric (mesh)	<b>£28</b>
<b>Seat options</b>	Backrest cushion (state thickness - 25, 50 or 75mm/ 1", 2" or 3")	<b>£72</b>
	Non standard seat	<b>£270</b>
	Seat skirt (for padded horseshoe and padded aperture seats only)	<b>£35</b>
	Extra padding (state thickness max +25mm/+ 1")	<b>£39</b>
	Reduced or no padding (state thickness)	<b>£22</b>
	Dartex seat covering	<b>£22</b>
	Side access seat extended by 50mm or 75mm	<b>£36</b>
	Change aperture dimension	<b>£39</b>
<b>Armrest options</b>	Pressure relief foam	<b>£22</b>
	Height increased or lowered (state height from top of seat)	<b>£39</b>
	Length change	<b>£39</b>
	Pair special soft pads	<b>£61</b>
	Pair padded armrests (state thickness - 25, 50 or 75mm/ 1", 2" or 3")	<b>£70</b>
	Pair gutter channel armrests	<b>£134</b>
	Front safety bar (includes special armrests)	<b>£38</b>
	Cranked armrests	<b>£26</b>
<b>Footrest options</b>	Bolted in armrests	<b>£47</b>
	Change footrest angle	<b>£24</b>
	Double length footplate (pair)	<b>£69</b>
	Velcro padding (per footrest)	<b>£54</b>
	Raise footrest height	<b>£39</b>
	Stump support (fixed, each)	<b>£150</b>
	Heel straps	<b>£49</b>
	Toe straps	<b>£49</b>
<b>Specialist</b>	Heel and toe straps	<b>£76</b>
	Thoracic supports (Ottobock) pair	<b>£308</b>
	Adjustable, removable headrest (Ottobock)	<b>£220</b>
	Chest and shoulder support harness (Ottobock)	<b>£90</b>

## Technical information

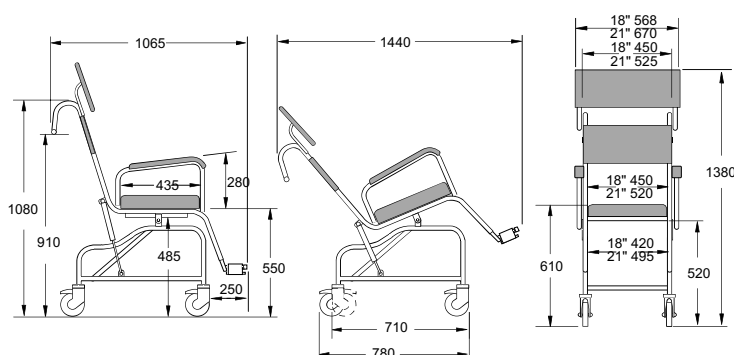

### SYMBOLS:

Bulk/oversized item



Made to order (see P198)



Tel: 01869 365500

www.chilterninvadex.co.uk

Fax: 01869 365588

sales@chilterninvadex.co.uk