

Mobile or Non Mobile Wooden Sitter Base

ASSEMBLY MANUAL

Helpful Tools



Bracket Hardware Kit

Parts

- > 4 Brackets
- > 8 Bracket Nuts
- > 8 Bracket Bolts



Caster Hardware Kit

Parts and Tools

- > 4 Casters (2 w/ brake)
- > 4 Caster Bolts
- > 4 Caster Nuts
- > 4 Lock washers



Non Mobile Hardware Kit

Parts

- > 4 Glides
- > 4 Lock washers
- > 4 Nuts



install: brackets x4

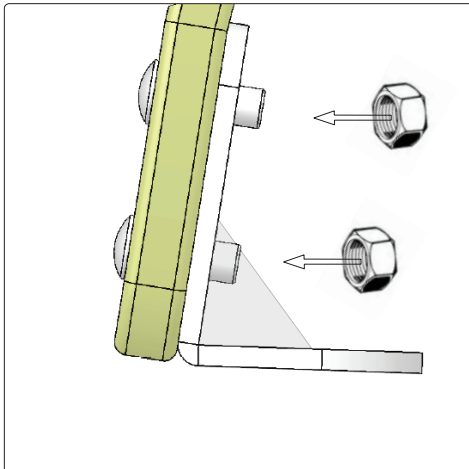

01 Bolt metal bracket to Wooden Base x4.
Note: Maintain tight screws.

install: casters x4

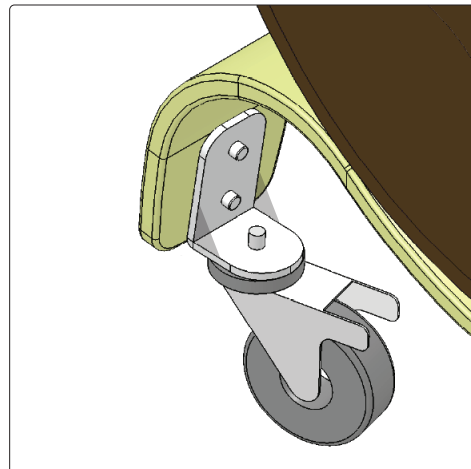

02 Be sure casters w/break are installed toward rear of base. This increases base strength.

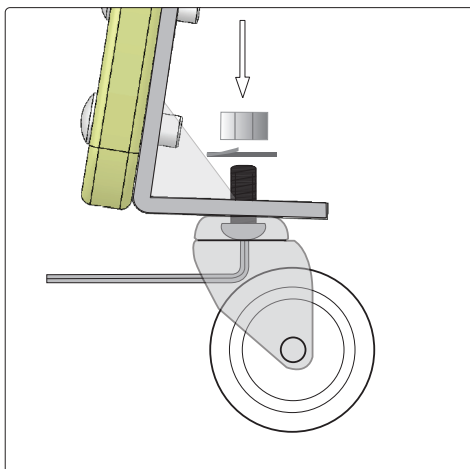

02a Use allen key to insert bolt up through the caster and bracket. Tighten nylon nuts with a crescent wrench. Note: Maintain tight screws.

non mobile only x4

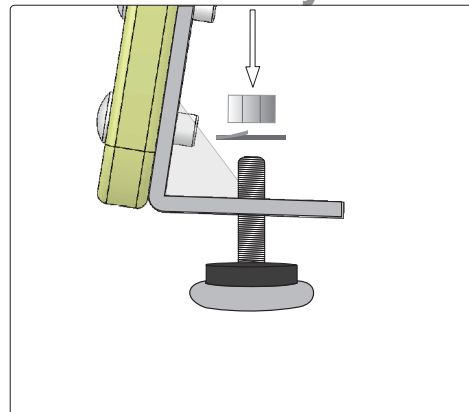

03 Feed Non mobile glide up through base bracket. Install lock washers then nut. Note: Maintain tight screws.